



# D'ANGLETERRE

COPENHAGEN  
EST. 1755

## MEETING & CONFERENCE 2019

FOR MORE THAN 260 YEARS THE D'ANGLETERRE HAS HOSTED AN ARRAY OF HISTORICAL EVENTS; FROM OFFICIAL GALAS, WEDDINGS, DIPLOMATIC RECEPTIONS AND ROYAL BANQUETS. THE NEWLY RENOVATED MEETINGS AND EVENTS FACILITIES AT THE HOTEL, OFFER THE ULTIMATE CONDITIONS FOR TAILOR MADE BUSINESS MEETINGS, CONFERENCES, PRODUCT LAUNCHES, PRIVATE FUNCTIONS AND DREAM WEDDINGS.

THE HISTORIC PALM COURT AND BALLROOM LOUIS XVI ARE STILL SOME OF THE MOST SOUGHT AFTER EVENTS AND CONFERENCE VENUES IN COPENHAGEN. ALL OUR MEETING AND CONFERENCE ROOMS FEATURE STATE OF THE ART AV EQUIPMENT INSTALLED IN 2013.

OUR DEDICATED EVENT TEAM WILL CUSTOMISE ANY EVENT TO CATER FOR SPECIFIC NEEDS, ENSURING AN EXPERIENCE THAT MATCHES HIGH EXPECTATIONS AND CREATES LONG LASTING MEMORIES.

### **PALM COURT**

THE RICH HISTORY OF THE PALM COURT TELLS A STORY OF PROMINENT GUESTS AND HISTORICAL EVENTS. THE INTERIOR DESIGN OF THE PALM COURT FEATURES THE LARGEST GLASS MOSAIC ROOF IN EUROPE AND WAS CREATED BY THE ITALIAN GLASS ARTIST ALBANO POLI.

### **LOUIS XVI**

PLENTY OF STATELY DINNERS AND EVENTS FOR DIGNITARIES, DIPLOMATS AND ARTIST HAVE BEEN HELD IN LOUIS XVI.

### **GALLERY**

THE MULTI-FUNCTIONAL GALLERY WITH ITS DELIGHTFUL, ORIGINAL CEILING AND THE VENETIAN CHANDELIERS IS IDEAL FOR DINNERS, CONFERENCES AND UNIQUE EVENTS.

### **EMPIRE**

THIS INTIMATE MEETING ROOM INTERCONNECTS WITH SALON IV AND SALON III FOR A UNIQUE AND PRIVATE SETTING FOR AN EVENT.

### **SALONS I, II, III & IV**

THESE ROOMS ARE IDEAL FOR SMALLER MEETINGS AND PRIVATE DINNERS. SALON I AND II AS WELL AS SALON III AND IV INTERCONNECT.

### **BALTHAZAR**

ON THE CORNER OF THE HOTEL COPENHAGEN'S FIRST CHAMPAGNE BAR IS LOCATED WHERE EXCLUSIVE CHAMPAGNES, SIGNATURE COCKTAILS OG SOPHISTICATED SNACKS. BALTHAZAR IS A PERFECT LOCATION FOR LARGER RECEPTIONS AND EVENTS.

### **D'ANGLETERRE CREATIONS**

THE BEAUTIFUL ATELIER THAT ARE LOCATED IN THE PARTERRE AT D'ANGLETERRE, HAS A RARELY SEEN ATMOSPHERE WHICH ARE IDEAL FOR INTIMATE COCKTAIL PARTIES, PRODUCT LAUNCHES OR PRE-DINNER DRINKS.



# D'ANGLETERRE

COPENHAGEN  
EST. 1755

## CONFERENCE PACKAGE - HALF DAY

08 AM - 12 NOON OR 1PM - 5PM

MEETING ROOM INCLUDING WI-FI, PENS, PADS, ICED WATER AND SWEETS.

LCD-PROJECTOR OR LED-SCREEN IS INCLUDED IN SALON I - III

LCD-PROJECTOR IN PALM COURT 6.900 DKK

LCD-PROJECTOR IN SALON IV, EMPIRE, GALLERY AND LOUIS XVI 2.400 DKK

### LIGHT BREAKFAST

STILL AND SPARKLING WATER, FRESHLY SQUEEZED JUICE, HOMEMADE BUTTER CROISSANT  
GREEK YOGHURT WITH FRESH FRUIT AND COFFEE & TEA

### BREAKS

MID-MORNING: 'ENERGIZER' INCL. HOMEMADE SMOOTHIE, VEGETABLE CRUDITÉS AND DRIED FRUITS

AFTERNOON: CLASSIC COFFEE BREAK INCL. COFFEE & TEA WITH HOMEMADE COOKIES

**2 COURSE LUNCH MENU**, SERVED IN THE MEETING ROOM

HEAD CHEF'S DAILY LUNCH MENU INCL. 1 DRINK PER PERSON

WITH BREAKFAST AND LUNCH

DKK 795 PER PERSON

WITH BREAKFAST *OR* LUNCH

DKK 695 PER PERSON

HEAD CHEF'S LUNCH BUFFET CAN BE ARRANGED WITH A SUPPLEMENT OF DKK 185 PER PERSON.

ABOVE RATES APPLY FOR MEETINGS 8 GUESTS AND ABOVE.

*DEPENDING ON THE SIZE OF THE MEETING ROOM, A MINIMUM NUMBER OF PACKAGES IS REQUIRED. FOR FURTHER INFORMATION PLEASE SEE THE SECTION "CONFERENCE ROOMS".*



# D'ANGLETERRE

COPENHAGEN  
EST. 1755

## CONFERENCE PACKAGE - FULL DAY

08 AM - 5PM

MEETING ROOM INCLUDING WI-FI, PENS, PADS, ICED WATER AND SWEETS.

LCD-PROJECTOR OR LED-SCREEN IS INCLUDED IN SALON I - III

LCD-PROJECTOR IN PALM COURT 6.900 DKK

LCD-PROJECTOR IN SALON IV, EMPIRE, GALLERY AND LOUIS XVI 2.400 DKK

### LIGHT BREAKFAST

STILL AND SPARKLING WATER, FRESHLY SQUEEZED JUICE, HOMEMADE BUTTER CROISSANT  
GREEK YOGHURT WITH FRESH FRUIT AND COFFEE & TEA

### ENERGIZER

HOMEMADE SMOOTHIE, VEGETABLE CRUDITÉS AND DRIED FRUITS

**2 COURSE LUNCH MENU**, SERVED IN THE MEETING ROOM

HEAD CHEF'S DAILY LUNCH MENU INCL. 1 DRINK PER PERSON

### CLASSIC COFFEE BREAK

COFFEE & TEA WITH HOMEMADE COOKIES

WITH BREAKFAST  
WITHOUT BREAKFAST

995 DKK PER PERSON  
875 DKK PER PERSON

HEAD CHEF'S LUNCH BUFFET CAN BE ARRANGED WITH A SUPPLEMENT OF DKK 185 PER PERSON.

ABOVE RATES APPLY FOR MEETINGS 8 GUESTS AND ABOVE.

*DEPENDING ON THE SIZE OF THE MEETING ROOM, A MINIMUM NUMBER OF PACKAGES IS REQUIRED. FOR FURTHER INFORMATION PLEASE SEE THE SECTION "CONFERENCE ROOMS".*



# D'ANGLETERRE

COPENHAGEN  
EST. 1755

## CONFERENCE MENU

(EXCLUDING ROOM RENTAL)

### CONTINENTAL BREAKFAST

250 DKK PER PERSON

COFFEE, TEA & ORANGE JUICE  
ASSORTED HOME BAKED ROLLS AND DANISH PASTRY, BUTTER & MARMALADES  
DANISH CHEESE & COLD CUTS

### BUSINESS BREAKFAST

295 DKK PER PERSON

COFFEE, TEA & ORANGE JUICE  
ASSORTED HOME BAKED ROLLS AND DANISH PASTRY, BUTTER & MARMALADES  
DANISH CHEESE & COLD CUTS  
SCRAMBLED EGGS, BACON & SAUSAGES  
GREEK YOGHURT WITH FRESH FRUIT SALAD

### BUSINESS LUNCH

FROM 475 DKK PER PERSON

HEAD CHEF'S DAILY 2-COURSE LUNCH MENU

### ENERGIZER

DKK 125 PER PERSON

HOMEMADE SMOOTHIE  
VEGETABLE CRUDITÉS  
DRIED FRUITS

### CLASSIC COFFEE BREAK

115 DKK PER PERSON

COFFEE & TEA  
HOMEMADE PASTRIES OR COOKIES



# D'ANGLETERRE

COPENHAGEN  
EST. 1755

## CONFERENCE MENU

(EXCLUDING ROOM RENTAL)

	PER PERSON
MOCCA & TEA (PER SERVING)	DKK 50
COFFEE & TEA, ALL DAY	DKK 110
DELUXE CIABATTA SANDWICH	DKK 150
DELUXE OPEN SANDWICH ON RYE BREAD (PER SANDWICH)	DKK 150
4 PIECES OF FINGER SANDWICHES	DKK 120
DANISH PASTRY	DKK 50
HOME BAKED CAKE	DKK 70
SELECTION OF HOME BAKED COOKIES	DKK 50
3 PIECES OF PETIT FOURS	DKK 90
FRESH FRUIT, HALFDAY	DKK 75
FRESH FRUIT, WHOLE DAY	DKK 130
	<b>PER UNIT</b>
HILDON MINERAL WATER (STILL/SPARKLING)	40 DKK / 65 DKK
SOFT DRINK	40 DKK
CARLSBERG BOTTLED BEER	50 DKK
JUICE	40 DKK
FRESHLY SQUEEZED JUICE	75 DKK



# D'ANGLETERRE

COPENHAGEN  
EST. 1755

## CONFERENCE ROOMS

	ALL DAY (8AM - 5PM)	HALF DAY (8AM - 12NOON) (1PM - 17PM)	EVENING (6PM-11PM)	MINIMUM NUMBER OF PACKAGES
SALON I	4.000 DKK	3.500 DKK	4.000 DKK	8
SALON II	4.500 DKK	4.000 DKK	4.500 DKK	16
SALON III	4.000 DKK	3.500 DKK	4.000 DKK	8
SALON IV	4.500 DKK	4.000 DKK	4.500 DKK	16
EMPIRE	8.000 DKK	7.500 DKK	8.000 DKK	25
GALLERY	17.000 DKK	17.000 DKK	17.000 DKK	ON REQUEST
LOUIS XVI	40.000 DKK	40.000 DKK	40.000 DKK	ON REQUEST
PALM COURT	70.000 DKK	70.000 DKK	70.000 DKK	ON REQUEST

MEETING ROOM INCLUDING WI-FI, PENS, PADS, ICED WATER AND SWEETS.

LCD-PROJECTOR OR LED-SCREEN IS INCLUDED IN SALON I - III

LCD-PROJECTOR IN PALM COURT 6.900 DKK

LCD-PROJECTOR IN SALON IV, EMPIRE, GALLERY AND LOUIS XVI 2.400 DKK

THERE IS A SUPPLEMENT OF 25% OF THE ROOM RENTAL (FULL DAY) FOR 24 HOUR ACCESS.



# D'ANGLETERRE

COPENHAGEN  
EST. 1755

## CONFERENCE EQUIPMENT

	PER DAY
STAGE (MAXIMUM 4 X 6 METER) FROM	1.000 DKK
FLIP-OVER	250 DKK
MICROPHONE, WIRELESS HANDHELD/HEADSET	800 DKK
LECTERN	800 DKK
CONFERENCE PHONE (EKSKLUSIV EXPENDITURE)	1.900 DKK
LCD PROJECTOR & SCREEN (SALON IV, EMPIRE, GALLERY & LOUIS XVI)	2.400 DKK
LCD PROJECTOR & SCREEN (PALM COURT)	6.900 DKK
LAPTOP FOR STANDARD PRESENTATIONS	1.800 DKK
TECHNICAL ASSISTANCE (RATE PER HOUR)	1.000 DKK

*FOR ANY FURTHER AV REQUESTS, PLEASE ADVISE AS WE HAVE AN EXTERNAL PARTNER FOR ANY ASSISTANCE.*

## FLOWER DECORATIONS

HOUSE CHOICE OF DECORATIONS	PER TABLE
HIGH COCKTAIL TABLES	350 DKK
ROUND TABLES	500 DKK
STAGE DECORATION	2.200 DKK

*D'ANGLETERRE ALSO OFFER TAILORMADE DECORATIONS AS PER REQUEST THROUGH OUR IN-HOUSE FLORIST, D'ANGLETERRE CREATIONS.*

FOR FURTHER INFORMATION, PLEASE CONTACT THE EVENT TEAM AT D'ANGLETERRE  
VIA PHONE: +45 7879 5196 OR E-MAIL: [EVENT@DANGLETERRE.COM](mailto:EVENT@DANGLETERRE.COM)



# D'ANGLETERRE

COPENHAGEN

EST. 1755

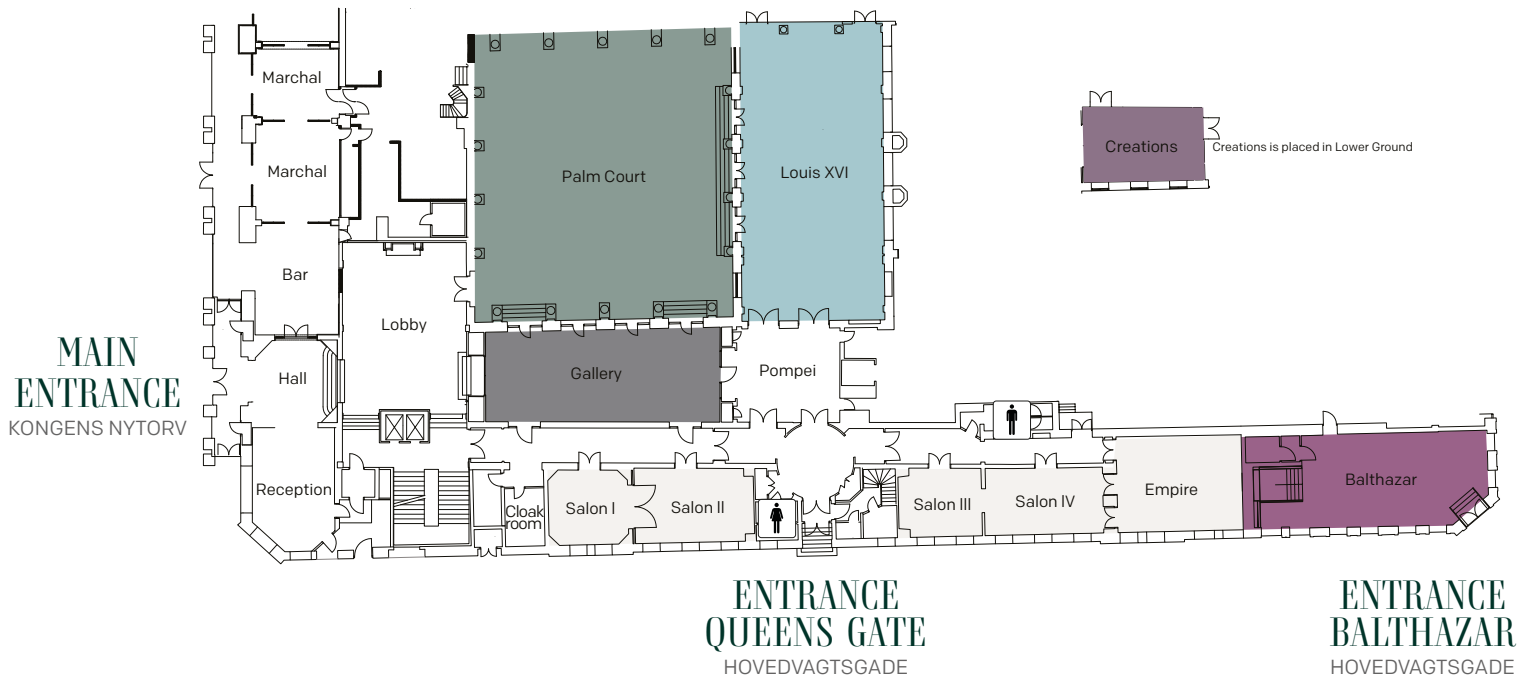

	Cabaret	Classroom	U-shaped	Theatre	Cocktails	Round Dining Tables	Boardroom	Dimensions Meter	Dimensions m <sup>2</sup>	Floor-to-ceiling height * Meter	Door width Meter	Door height Meter
Salon I	-	-	-	-	15	10	10	5,5 x 5,2	29	3,7	1,45	2,26
II	-	-	-	-	25	20	20	8,3 x 5,1	42	3,7	1,45	2,70
III	-	-	-	-	15	10	10	5,7 x 4,6	26	3,6	1,45	2,37
IV	-	-	-	-	25	20	20	8,3 x 4,5	37	3,5	1,42	2,81
Empire	25	25	25	25	50	50	25	8,8 x 6,5	57	3,6	1,40	2,80
Gallery	35	50	40	100	100	60	30	15,6 x 6,0	94	7,2 *	2,50	2,50
Louis XVI	70	90	50	200	250	130	50	18,7 x 9,8	183	7,2 *	1,80	2,50
Palm Court	120	196	60	300	400	300	-	18,0 x 16,1	290	9,1	1,80	2,40
Balthazar	-	-	-	-	100	-	-	16,0 x 6,0	96	4,1	2,10	3,50
Creations	-	-	-	-	40	-	-	10,5 x 5,2	54,6	2,4	0,85	2,00/2,05

\*Chandeliers might lower ceiling height  
All mentioned numbers are excluding stage and AV equipment