

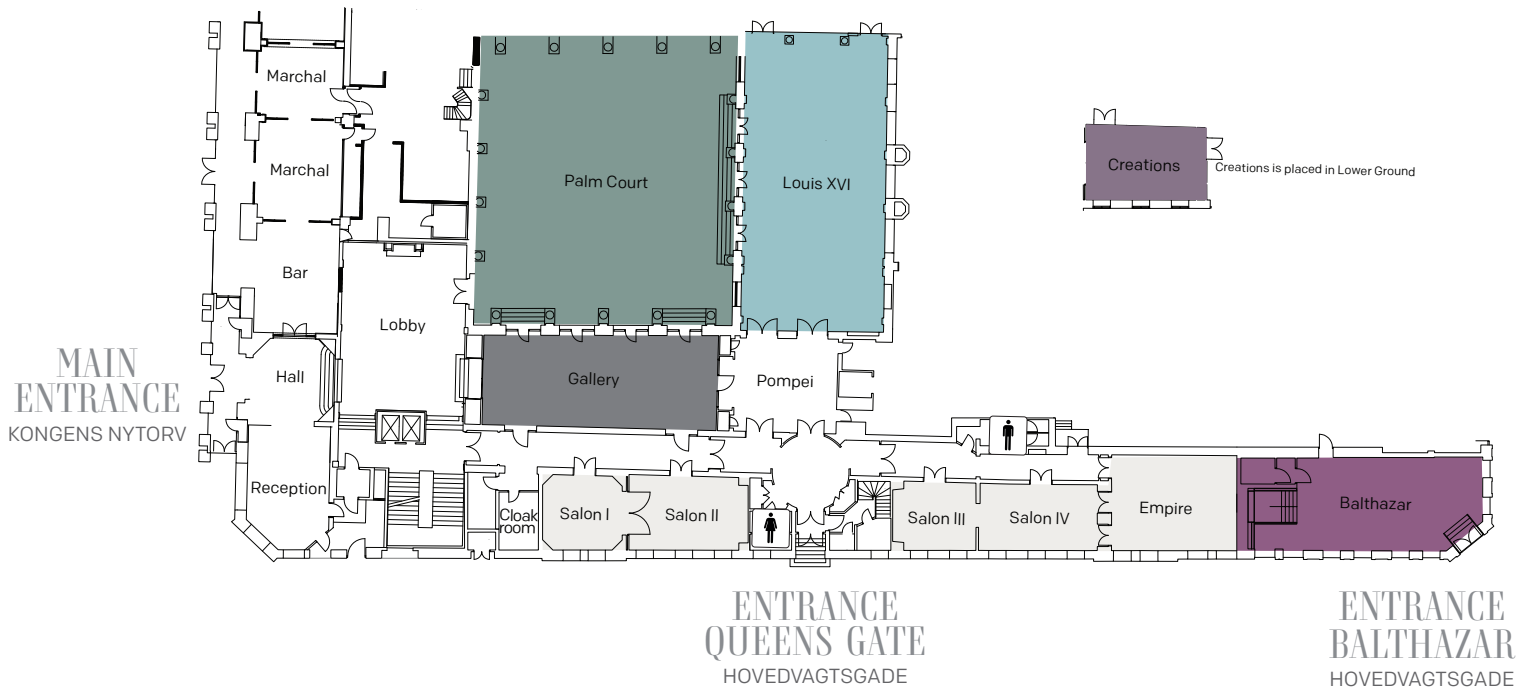

D'ANGLETERRE

COPENHAGEN

EST 1755



| | Cabaret | Classroom | U-shaped | Theatre | Cocktails | Round Dining Tables | Boardroom | Dimensions Meter | Dimensions m ² | Floor-to-ceiling height * Meter | Door width Meter | Door height Meter |
|------------|---------|-----------|----------|---------|-----------|---------------------|-----------|------------------|---------------------------|---------------------------------|------------------|-------------------|
| Salon I | 8 | 10 | - | 15 | 15 | 10 | 10 | 5,5 x 5,2 | 29 | 3,7 | 1,45 | 2,26 |
| II | 16 | 20 | - | 30 | 25 | 20 | 18 | 8,3 x 5,1 | 42 | 3,7 | 1,45 | 2,70 |
| III | 8 | 10 | - | 15 | 15 | 10 | 10 | 5,7 x 4,6 | 26 | 3,6 | 1,45 | 2,37 |
| IV | 16 | 20 | - | 30 | 25 | 20 | 18 | 8,3 x 4,5 | 37 | 3,5 | 1,42 | 2,81 |
| Empire | 28 | 30 | 25 | 40 | 50 | 40 | 22 | 8,8 x 6,5 | 57 | 3,6 | 1,40 | 2,80 |
| Gallery | 30 | 40 | 35 | 100 | 100 | 70 | 30 | 15,6 x 6,0 | 94 | 7,2 * | 2,50 | 2,50 |
| Louis XVI | 80 | 90 | 50 | 200 | 200 | 140 | 40 | 18,7 x 9,8 | 183 | 7,2 * | 1,80 | 2,50 |
| Palm Court | 120 | 200 | 70 | 300 | 400 | 300 | - | 18,0 x 16,1 | 290 | 9,1 | 1,80 | 2,40 |
| Balthazar | - | - | - | - | 100 | - | - | 16,0 x 6,0 | 96 | 4,1 | 2,10 | 3,50 |
| CREATIONS | - | - | - | - | 40 | - | - | 10,5 x 5,2 | 54,6 | 2,4 | 0,85 | 2,00/2,05 |

*Chandeliers might lower ceiling height
All mentioned numbers are excluding stage and AV equipment